

# 2018 CAPITAL PROJECT

This proposal is the culmination of two years of District, Long Range Planning Committee, focus & architectural work, and Board of Education discussion. The proposal is designed to transform several key common, programmatic and instructional areas across the District:

## HIGH SCHOOL

1. Improve the safety and security of students and staff
2. Creation of two new state-of-the-art High School Science classrooms
3. Creation of new Science Research facility
4. Transform the Library into a tech friendly collaboration space for students & staff
5. Creation of a new High School Guidance Office and College Conference Room
6. Renovation of the High School Maresca Center for Guided Instruction and Support
7. The creation of new Writing and Math Labs
8. Renovation of Music and Performing Arts Classrooms
9. Elimination of windowless interior adapted to serve as classrooms
10. Eliminate the use of closet/former office spaces for educational support activities
11. Renovate the Kitchen serving area

## MIDDLE SCHOOL

1. Improve the safety and security of students and staff
2. Creation of a "Maker Space" for hands-on learning
3. Renovate Music and Performing Arts classrooms

## TODD SCHOOL

1. Improve the safety and security of students and staff
2. Creation of new performance/special event & indoor recreational space (existing Gym)
3. Creation of new gymnasium
4. Creation of an outdoor learning space
5. Creation of a special needs and student support suite
6. Consolidation of the administrative, nursing and conference space

## BOND REFERENDUM

Thursday, December 13th 6:00 AM - 9:00 PM  
Todd Elementary School K-2 Cafeteria



## Every student, every day...

### Why this project?

- Promotes the **Health, Safety and Security** of students and staff.
- Supports **Next Generation Learning Standards** and instructional practices at the HS & MS.
- Provides much-needed **performance and flexible use** space at Todd Elementary School.
- Addresses **High Priority Infrastructure Needs**.



Every student, every day...

KG-D

### Why now?

- Core spaces at Todd and the High School have not been significantly renovated in **50 +/- years**.
- This is a **smart time** to make a capital reinvestment.
  - The District has significant retiring debt service.
  - Borrowing rates remain low.
  - Construction costs are projected to escalate moving forward.
- By replacing debt service, funding for necessary maintenance and improvements can be accomplished **without requiring an increase to the tax levy above current levels**.



Every student, every day...

KG-D

### Todd Elementary School

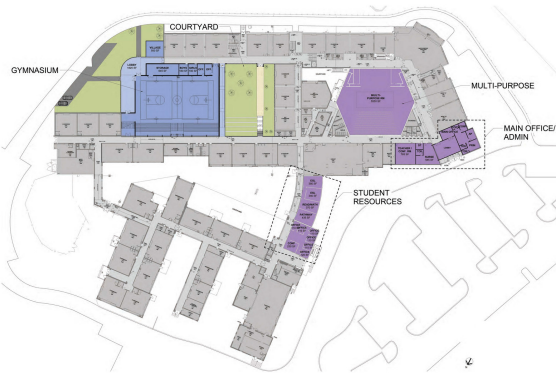

Every student, every day...

KG-D

### HS/MS Second Floor



Every student, every day...

KG-D

### HS/MS First Floor



Every student, every day...

KG-D

For more information visit  
[briarcliffschools.org/capital-project](http://briarcliffschools.org/capital-project)

