

A Renovate Old Library	5,103 SF @	\$ 400 per SF =	\$ 2,041,200
B Renovate Old Maresca Center	3,322 SF @	\$ 400 per SF =	\$ 1,328,800
C Eliminate Dividing Corridor	780 SF @	\$ 400 per SF =	\$ 312,000
D 108 as Amphitheatre Element	1,694 SF @	\$ 400 per SF =	\$ 677,600
E Incorporate 112, 113 & Hallway	2,744 SF @	\$ 400 per SF =	\$ 1,097,600
F Combine 120 Art & 121 Tech	2,329 SF @	\$ 400 per SF =	\$ 931,600
G Incorporate 114, 115 & Entry	1,974 SF @	\$ 400 per SF =	\$ 789,600
H Clear Access to Cafeteria	2,019 SF @	\$ 400 per SF =	\$ 807,600
			\$ 7,986,000

ONE	TWO	THREE	FOUR	FIVE	SIX	SEVEN	EIGHT
\$ 2,041,200	\$ 2,041,200	\$ 2,041,200	\$ 2,041,200	\$ 2,041,200	\$ 2,041,200	\$ 2,041,200	\$ 2,041,200
	\$ 1,328,800	\$ 1,328,800	\$ 1,328,800	\$ 1,328,800	\$ 1,328,800	\$ 1,328,800	\$ 1,328,800
		\$ 312,000	\$ 312,000	\$ 312,000	\$ 312,000	\$ 312,000	\$ 312,000
			\$ 677,600	\$ 677,600	\$ 677,600	\$ 677,600	\$ 677,600
				\$ 1,097,600	\$ 1,097,600	\$ 1,097,600	\$ 1,097,600
					\$ 931,600	\$ 931,600	\$ 931,600
						\$ 789,600	\$ 789,600
							\$ 807,600
\$ 2,041,200	\$ 3,370,000	\$ 3,682,000	\$ 4,359,600	\$ 5,457,200	\$ 6,388,800	\$ 7,178,400	\$ 7,986,000

A Renovate Old Library	5,103 SF @ \$ 400 per SF =	\$ 2,041,200
B Renovate Old Maresca Center	3,322 SF @ \$ 400 per SF =	\$ 1,328,800
C Eliminate Dividing Corridor	780 SF @ \$ 400 per SF =	\$ 312,000
D 108 as Amphitheatre Element	1,694 SF @ \$ 400 per SF =	\$ 677,600
E Incorporate 112, 113 & Hallway	2,744 SF @ \$ 400 per SF =	\$ 1,097,600
F Combine 120 Art & 121 Tech	2,329 SF @ \$ 400 per SF =	\$ 931,600
G Incorporate 114, 115 & Entry	1,974 SF @ \$ 400 per SF =	\$ 789,600
H Clear Access to Cafeteria	2,019 SF @ \$ 400 per SF =	\$ 807,600
		\$ 7,986,000

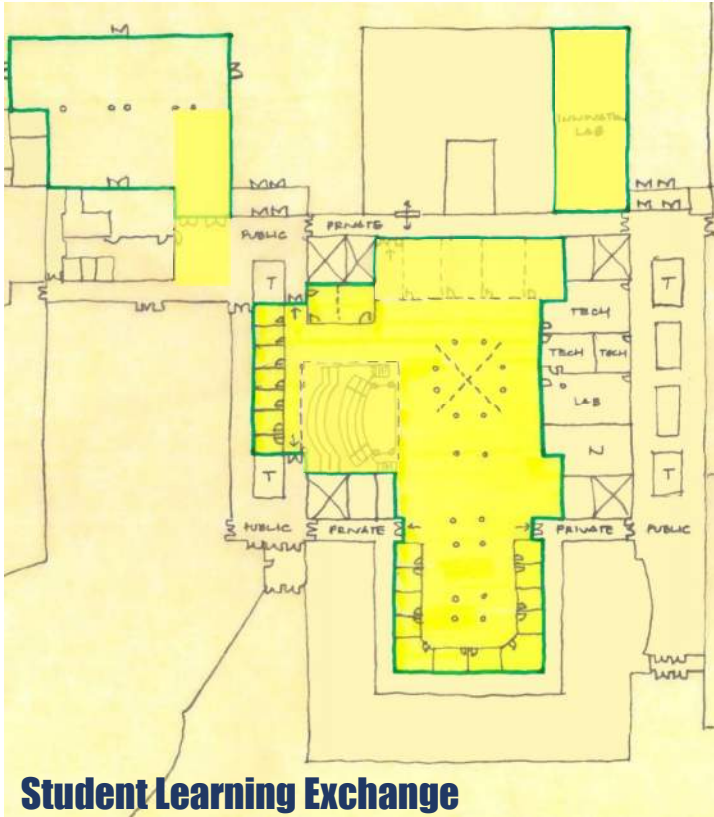

Student Learning Exchange

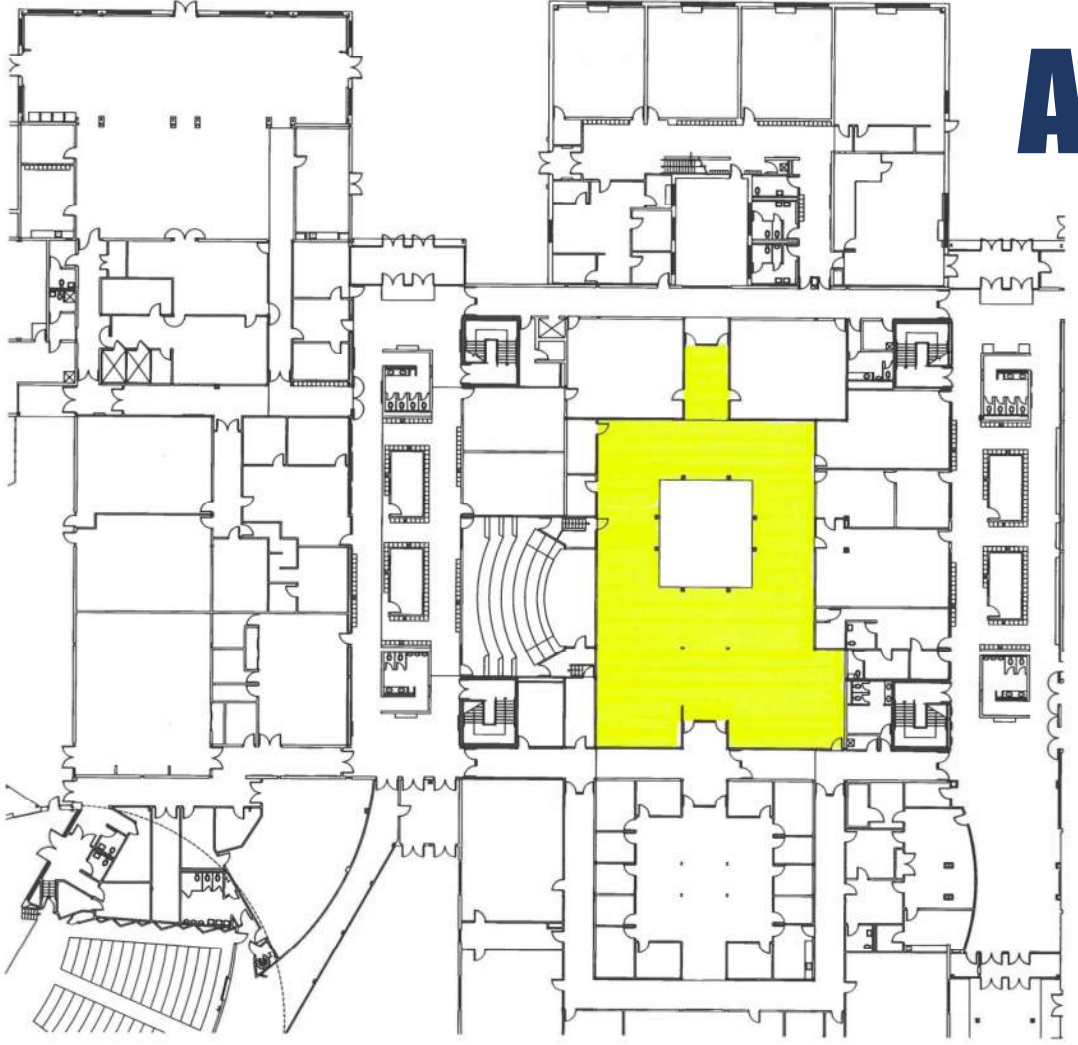

B



A Renovate Old Library	5,103 SF @	\$ 400 per SF =	\$ 2,041,200
B Renovate Old Maresca Center	3,322 SF @	\$ 400 per SF =	\$ 1,328,800
C Eliminate Dividing Corridor	780 SF @	\$ 400 per SF =	\$ 312,000
D 108 as Amphitheatre Element	1,694 SF @	\$ 400 per SF =	\$ 677,600
E Incorporate 112, 113 & Hallway	2,744 SF @	\$ 400 per SF =	\$ 1,097,600
F Combine 120 Art & 121 Tech	2,329 SF @	\$ 400 per SF =	\$ 931,600
G Incorporate 114, 115 & Entry	1,974 SF @	\$ 400 per SF =	\$ 789,600
H Clear Access to Cafeteria	2,019 SF @	\$ 400 per SF =	\$ 807,600

\$ 7,986,000

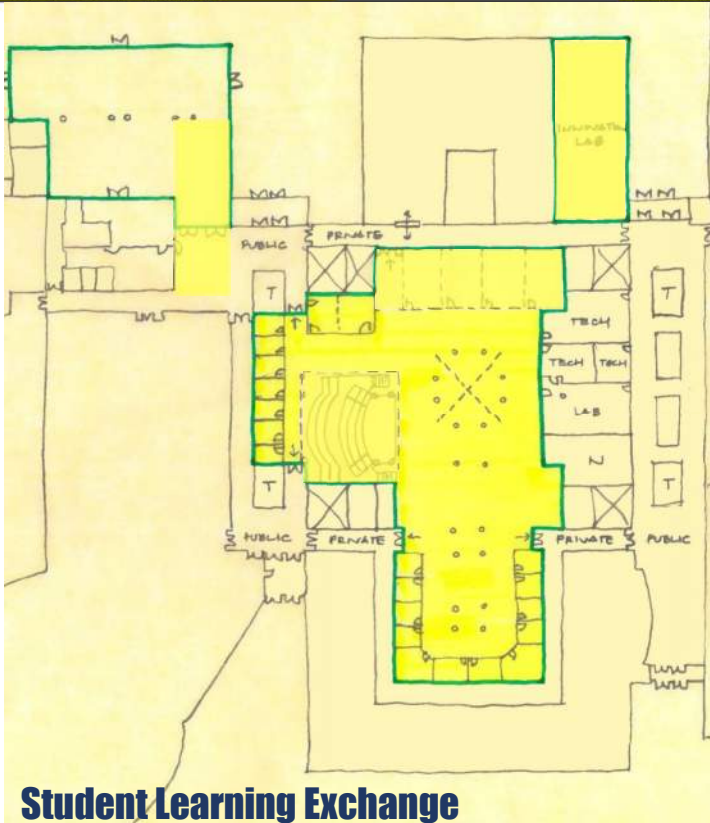

Student Learning Exchange

C

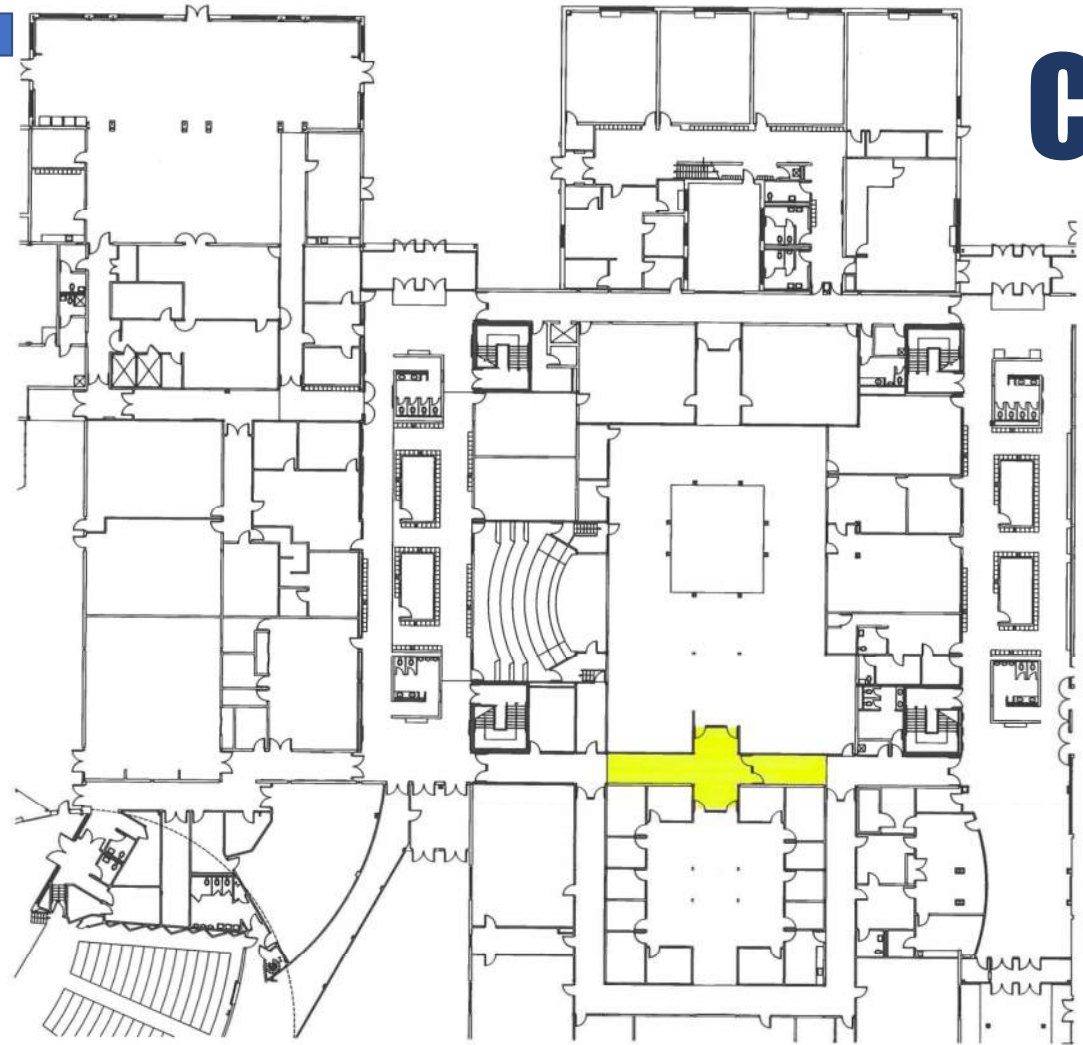

A Renovate Old Library	5,103 SF @	\$ 400 per SF =	\$ 2,041,200
B Renovate Old Maresca Center	3,322 SF @	\$ 400 per SF =	\$ 1,328,800
C Eliminate Dividing Corridor	780 SF @	\$ 400 per SF =	\$ 312,000
D 108 as Amphitheatre Element	1,694 SF @	\$ 400 per SF =	\$ 677,600
E Incorporate 112, 113 & Hallway	2,744 SF @	\$ 400 per SF =	\$ 1,097,600
F Combine 120 Art & 121 Tech	2,329 SF @	\$ 400 per SF =	\$ 931,600
G Incorporate 114, 115 & Entry	1,974 SF @	\$ 400 per SF =	\$ 789,600
H Clear Access to Cafeteria	2,019 SF @	\$ 400 per SF =	\$ 807,600

\$ 7,986,000

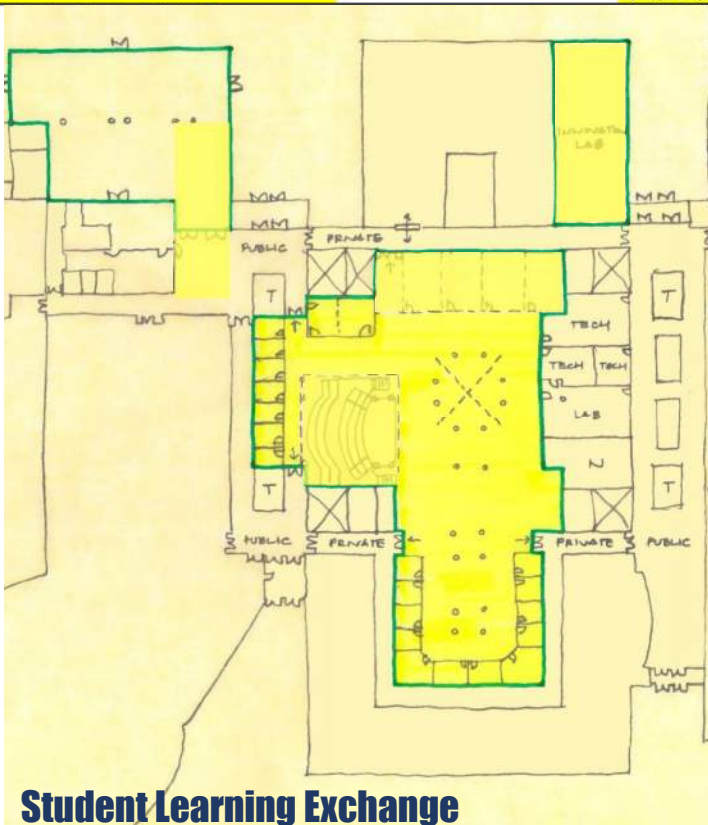

Student Learning Exchange

D

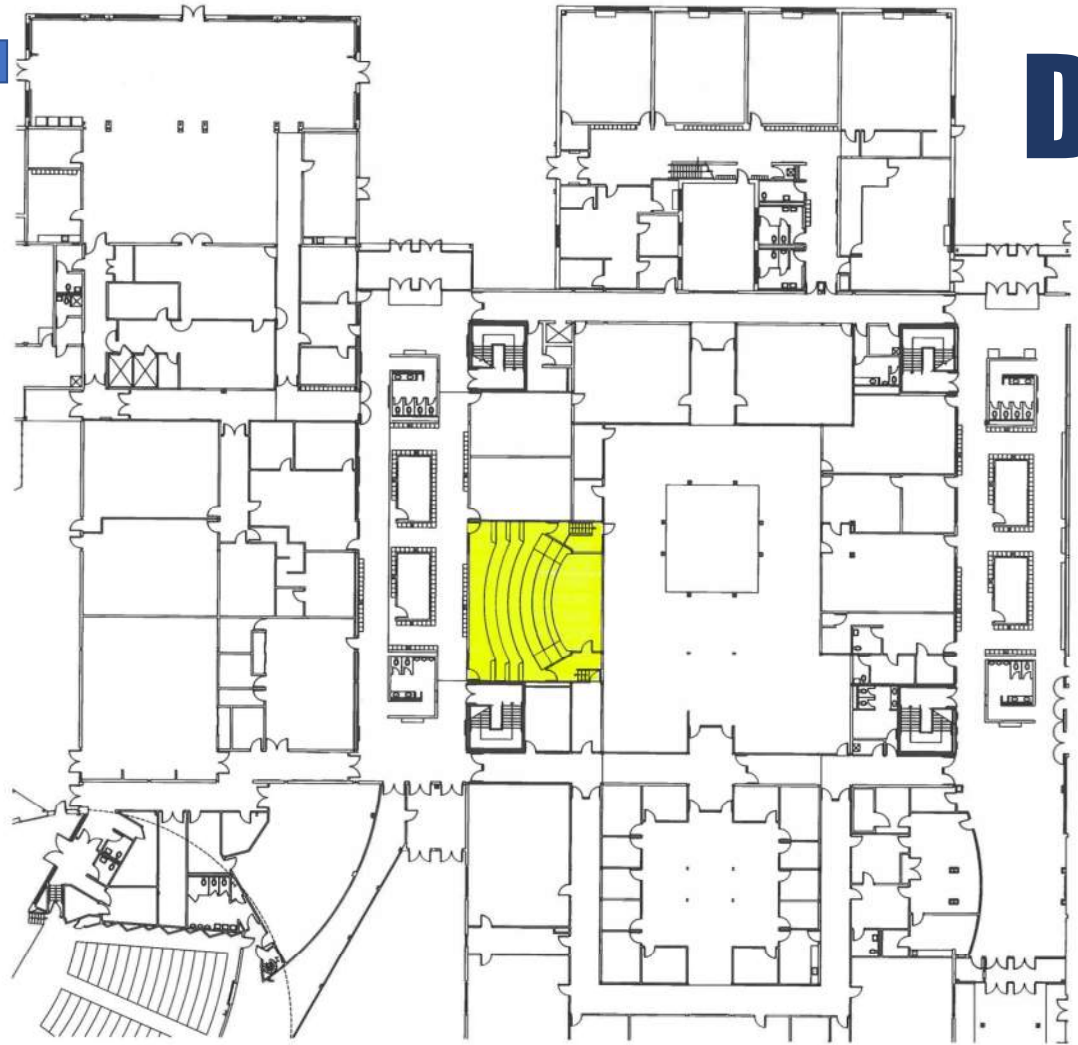

A Renovate Old Library	5,103 SF @ \$ 400 per SF =	\$ 2,041,200
B Renovate Old Maresca Center	3,322 SF @ \$ 400 per SF =	\$ 1,328,800
C Eliminate Dividing Corridor	780 SF @ \$ 400 per SF =	\$ 312,000
D 108 as Amphitheatre Element	1,694 SF @ \$ 400 per SF =	\$ 677,600
E Incorporate 112, 113 & Hallway	2,744 SF @ \$ 400 per SF =	\$ 1,097,600
F Combine 120 Art & 121 Tech	2,329 SF @ \$ 400 per SF =	\$ 931,600
G Incorporate 114, 115 & Entry	1,974 SF @ \$ 400 per SF =	\$ 789,600
H Clear Access to Cafeteria	2,019 SF @ \$ 400 per SF =	\$ 807,600
		\$ 7,986,000

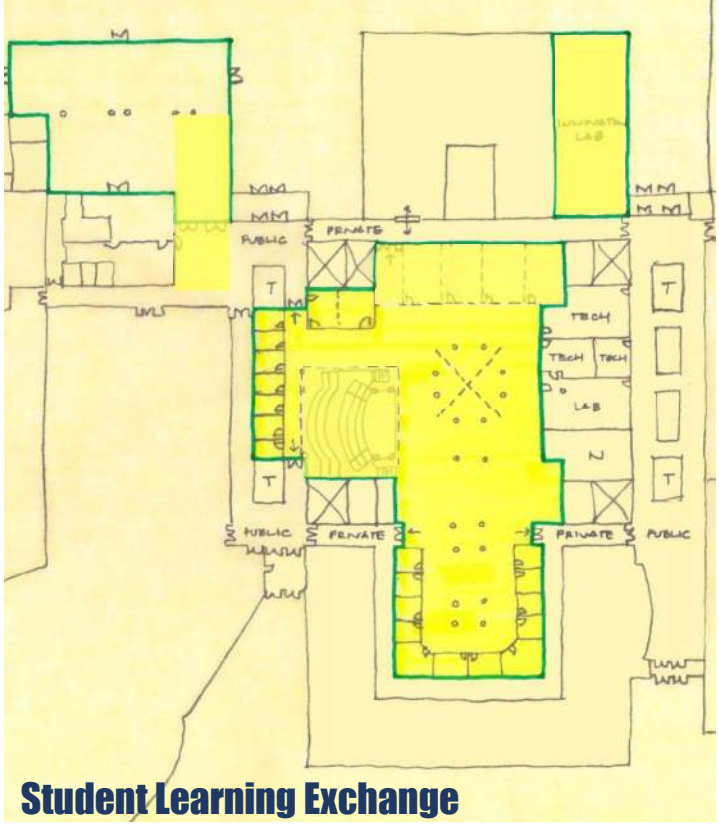

Student Learning Exchange

A Renovate Old Library	5,103 SF @ \$ 400 per SF =	\$ 2,041,200
B Renovate Old Maresca Center	3,322 SF @ \$ 400 per SF =	\$ 1,328,800
C Eliminate Dividing Corridor	780 SF @ \$ 400 per SF =	\$ 312,000
D 108 as Amphitheatre Element	1,694 SF @ \$ 400 per SF =	\$ 677,600
E Incorporate 112, 113 & Hallway	2,744 SF @ \$ 400 per SF =	\$ 1,097,600
F Combine 120 Art & 121 Tech	2,329 SF @ \$ 400 per SF =	\$ 931,600
G Incorporate 114, 115 & Entry	1,974 SF @ \$ 400 per SF =	\$ 789,600
H Clear Access to Cafeteria	2,019 SF @ \$ 400 per SF =	\$ 807,600
		\$ 7,986,000

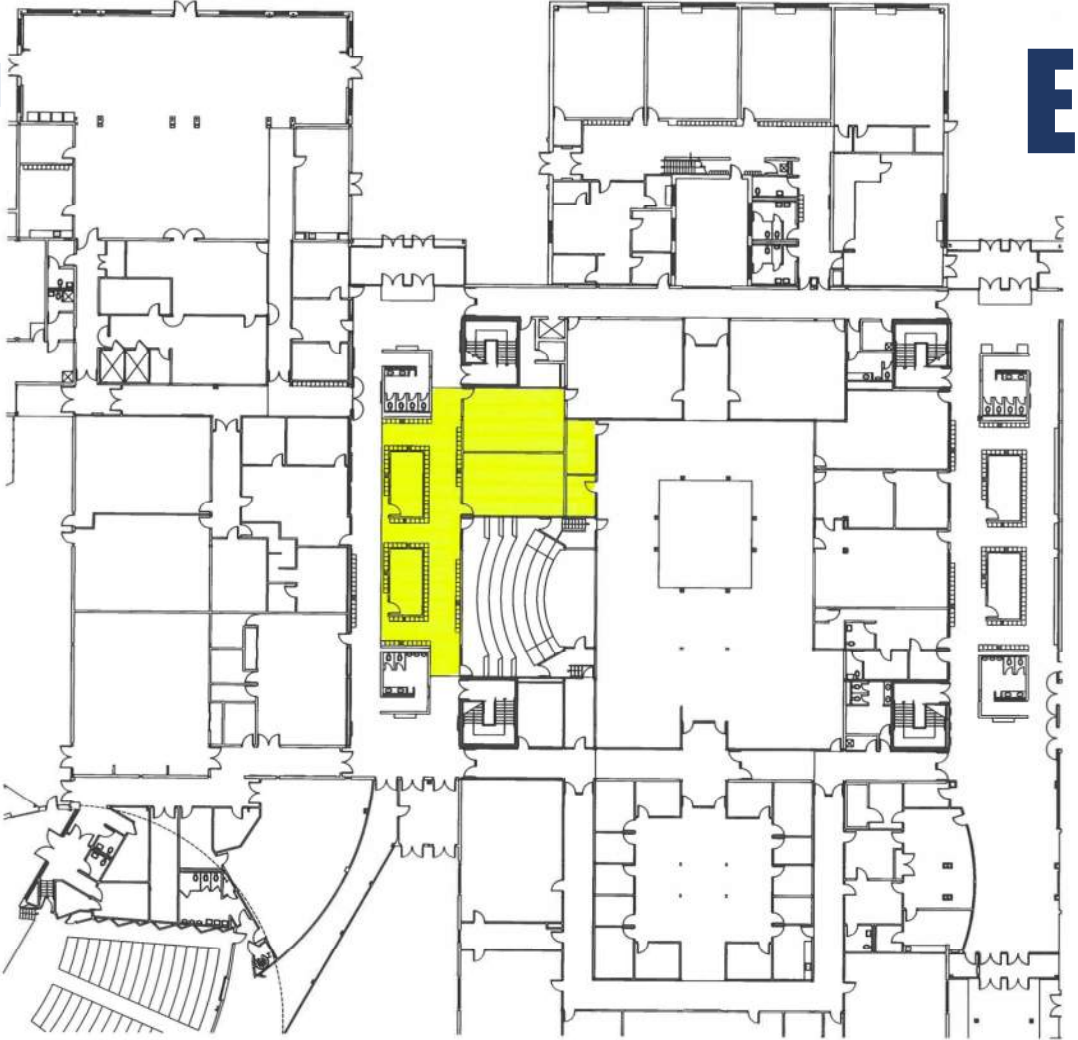
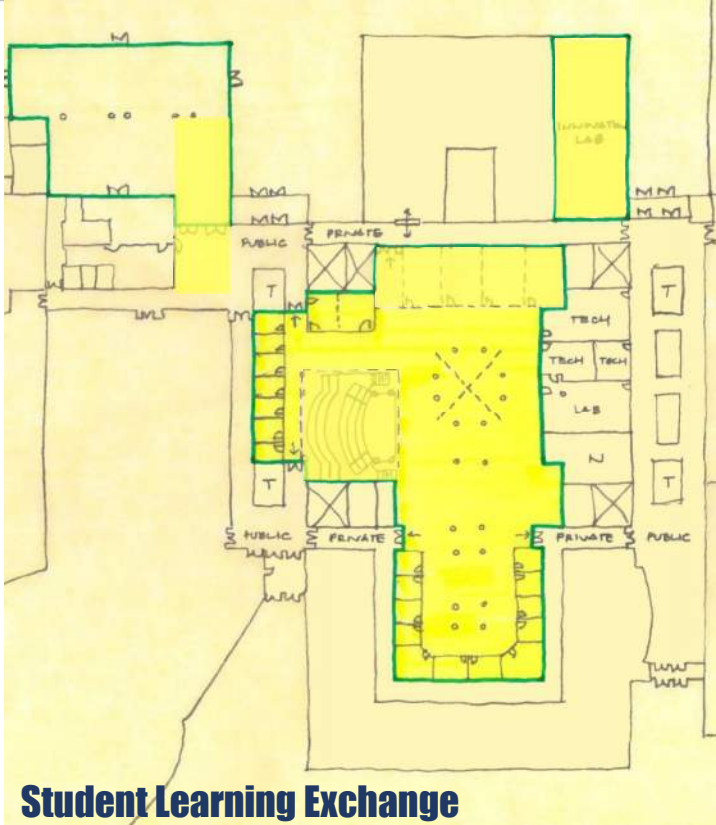

A Renovate Old Library	5,103 SF @ \$ 400 per SF =	\$ 2,041,200
B Renovate Old Maresca Center	3,322 SF @ \$ 400 per SF =	\$ 1,328,800
C Eliminate Dividing Corridor	780 SF @ \$ 400 per SF =	\$ 312,000
D 108 as Amphitheatre Element	1,694 SF @ \$ 400 per SF =	\$ 677,600
E Incorporate 112, 113 & Hallway	2,744 SF @ \$ 400 per SF =	\$ 1,097,600
F Combine 120 Art & 121 Tech	2,329 SF @ \$ 400 per SF =	\$ 931,600
G Incorporate 114, 115 & Entry	1,974 SF @ \$ 400 per SF =	\$ 789,600
H Clear Access to Cafeteria	2,019 SF @ \$ 400 per SF =	\$ 807,600
		\$ 7,986,000

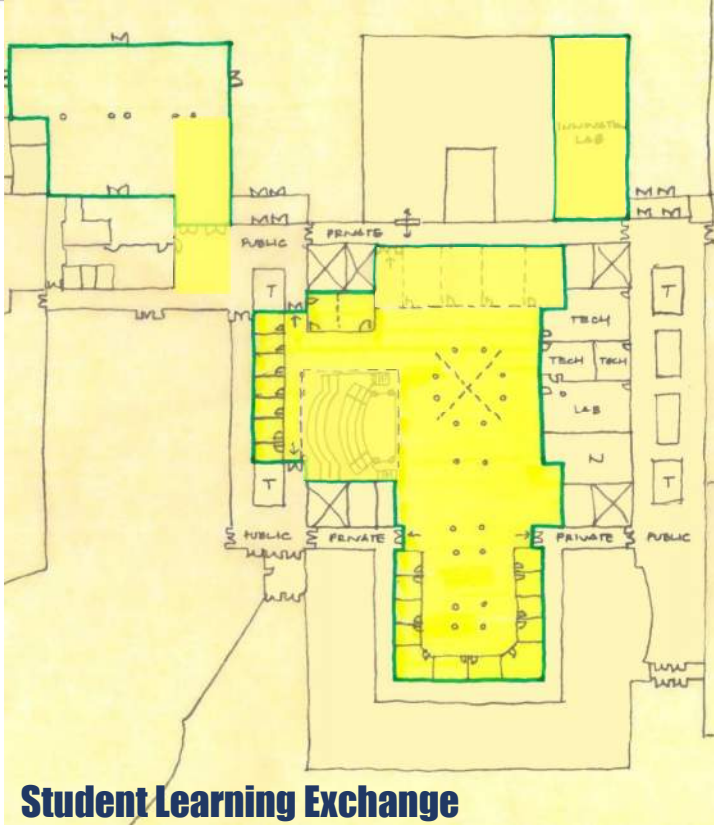

Student Learning Exchange



G

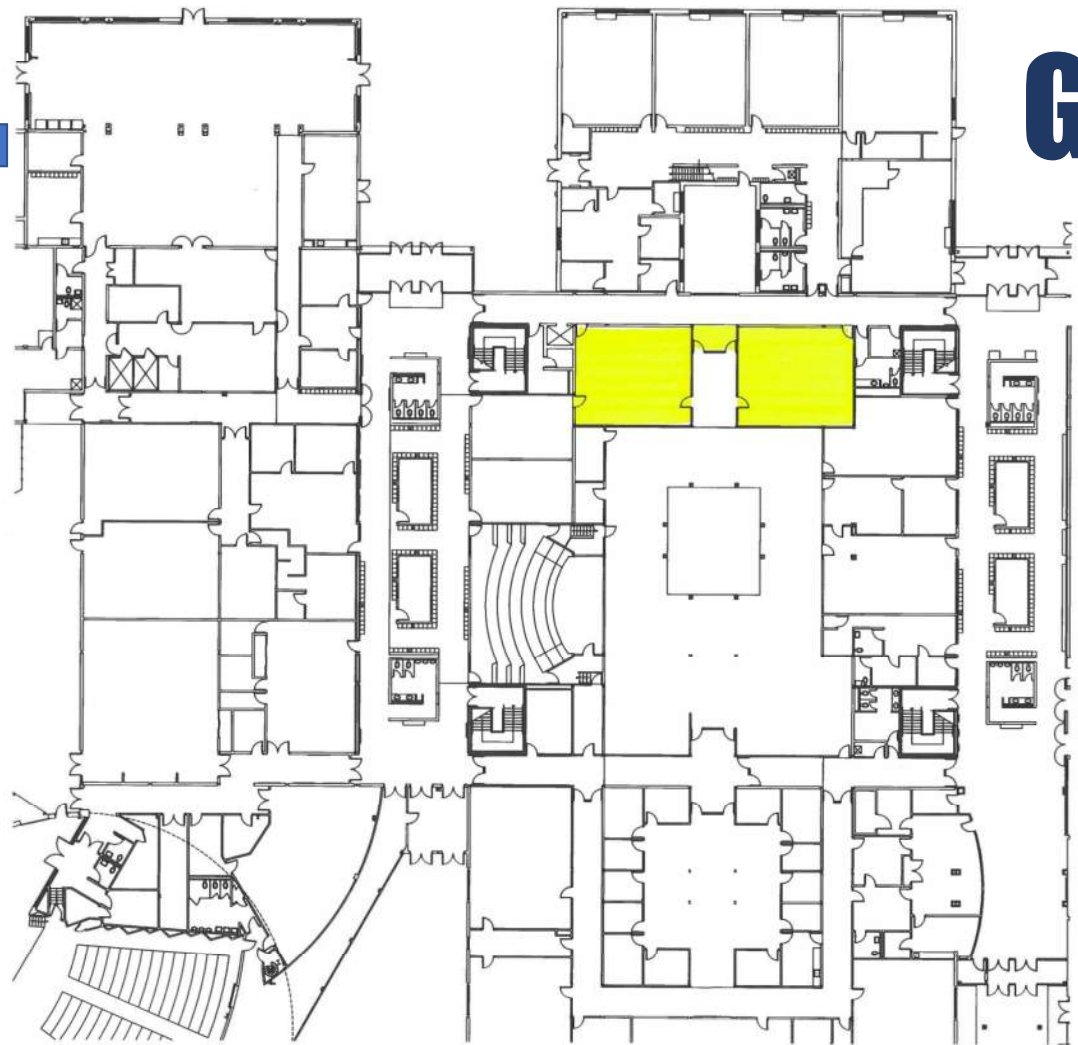

A Renovate Old Library	5,103 SF @ \$ 400 per SF =	\$ 2,041,200
B Renovate Old Maresca Center	3,322 SF @ \$ 400 per SF =	\$ 1,328,800
C Eliminate Dividing Corridor	780 SF @ \$ 400 per SF =	\$ 312,000
D 108 as Amphitheatre Element	1,694 SF @ \$ 400 per SF =	\$ 677,600
E Incorporate 112, 113 & Hallway	2,744 SF @ \$ 400 per SF =	\$ 1,097,600
F Combine 120 Art & 121 Tech	2,329 SF @ \$ 400 per SF =	\$ 931,600
G Incorporate 114, 115 & Entry	1,974 SF @ \$ 400 per SF =	\$ 789,600
H Clear Access to Cafeteria	2,019 SF @ \$ 400 per SF =	\$ 807,600
		\$ 7,986,000

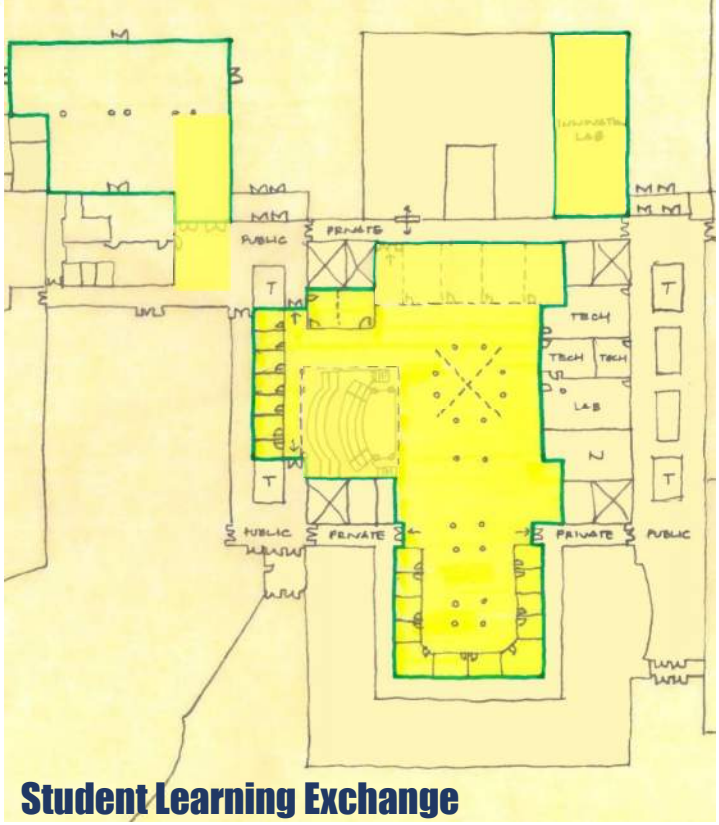

Student Learning Exchange

H

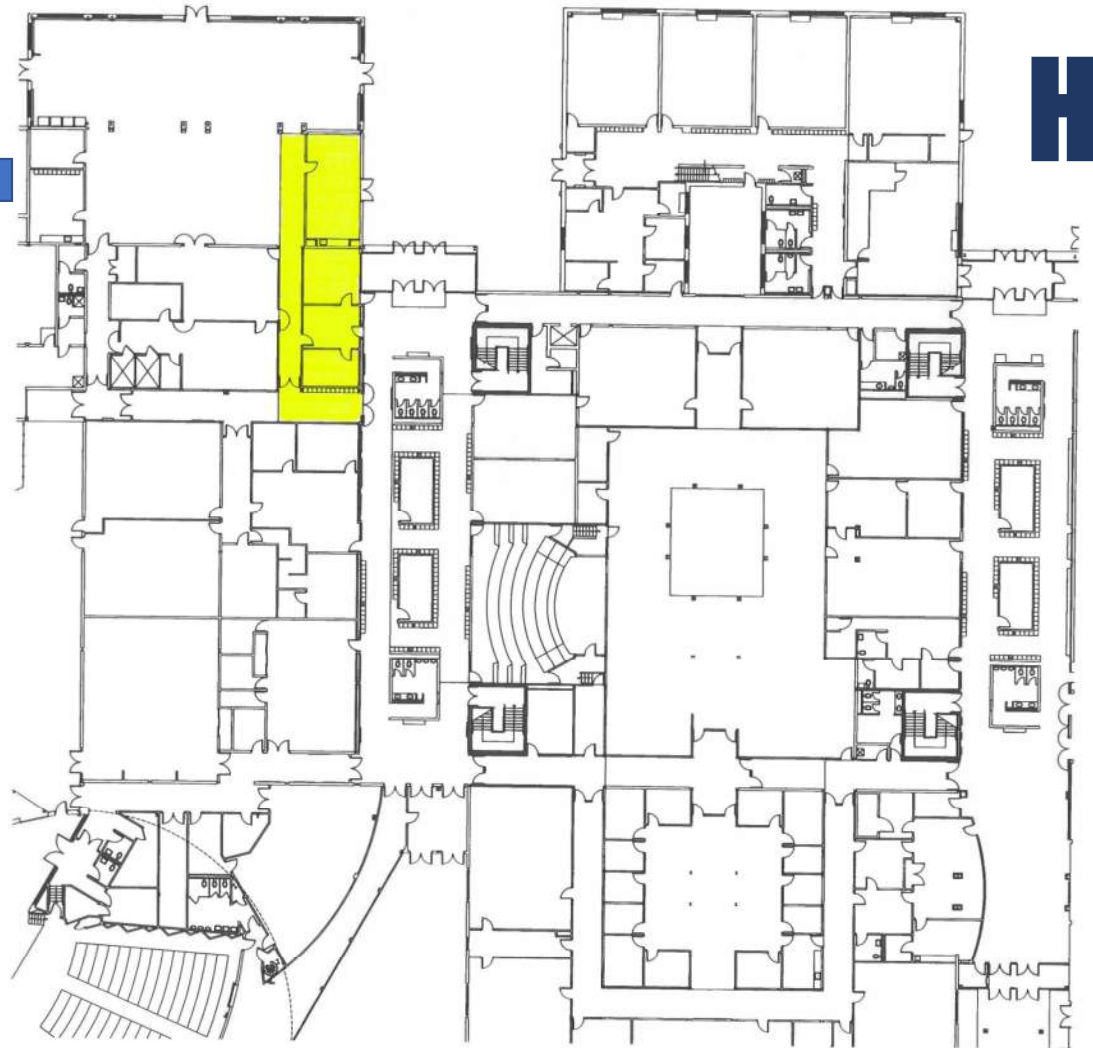

A Renovate Old Library	5,103 SF @ \$ 400 per SF =	\$ 2,041,200
B Renovate Old Maresca Center	3,322 SF @ \$ 400 per SF =	\$ 1,328,800
C Eliminate Dividing Corridor	780 SF @ \$ 400 per SF =	\$ 312,000
D 108 as Amphitheatre Element	1,694 SF @ \$ 400 per SF =	\$ 677,600
E Incorporate 112, 113 & Hallway	2,744 SF @ \$ 400 per SF =	\$ 1,097,600
F Combine 120 Art & 121 Tech	2,329 SF @ \$ 400 per SF =	\$ 931,600
G Incorporate 114, 115 & Entry	1,974 SF @ \$ 400 per SF =	\$ 789,600
H Clear Access to Cafeteria	2,019 SF @ \$ 400 per SF =	\$ 807,600
		\$ 7,986,000

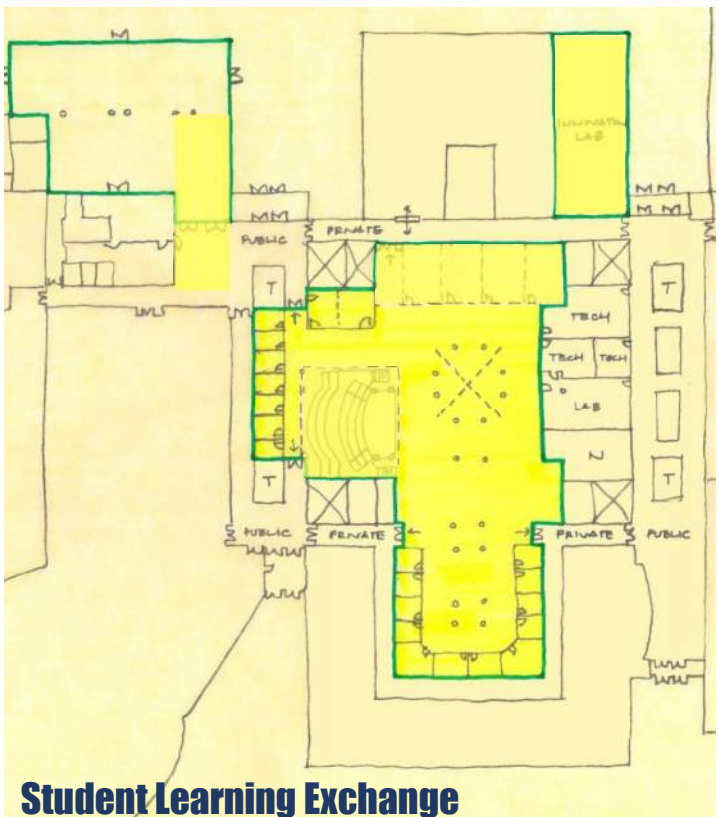

Student Learning Exchange